

# RESIDENTIAL BROCHURE

WINTER 2025



KANATA EXECUTIVE LINE  
DESIGN: T01 | DARK WALNUT



upwardor

Garage Doors Designed for Life

# Table Of Contents

---

**4** THE KANATA COLLECTION™

**6** THE CRAFT SERIES™

**8** **AL-976™**  
Aluminum Doors

**9** KANATA EXECUTIVE LINE

**10** LIFTMASTER & GARAGE ORGANIZATION

**11** MEASUREMENTS & SPECIFICATIONS



# Trust Upwardor Quality Craftsmanship

---

For over **50** years, thousands of homeowners every year choose Upwardor. We are a leader in manufacturing quality doors that last! Our Dealers are selectively chosen because of their attention to detail and customer service.

Call **1-800-667-3367** to find out more  
or visit [upwardor.com](http://upwardor.com)

**Telephone: 905-876-3667**  
**Fax: 905-876-3533**  
**Email: [sales@upwardor.com](mailto:sales@upwardor.com)**

Shown:

Design: Bronte Creek | Steel Grey

**Quality Crafted,  
Uniquely Styled.**

Since 1974

---

**Residential Line**



upwardor

Garage Doors Designed for Life

Shown:  
Design: Sheridan XL | White

# The Kanata Collection™

Combines style, durability and environmental friendliness. Polyurethane insulation is foamed in place, which ensures a consistent density and significant panel strength. With a 1<sup>3/4</sup>" (44.5mm) thickness, R-value of 16.3, enhanced tongue and groove joint and a true thermal break, the Kanata Collection is an excellent choice for those who are looking for a high-quality, energy efficient residential garage door.



## Customize Your Look!

Choose your own custom colours to match your home!

## Colour Choices

- White
- New Almond
- Black
- Walnut
- Iron Ore
- Sandtone
- New Brown
- Bronze
- Steel Grey
- Hazelwood



Shown:  
Design: Flush  
Black





**Shown:**  
Design: Sheridan XL | Bronze

## The Kanata Collection™

Upwardor offers several design and decorative insert options, adding a custom touch to your garage door. Window inserts are interchangeable, providing a classic or decorative look to complement and add value to your home. Frames and inserts are carefully colour-matched and are UV protected.

## Features and Options

- High-quality, versatile and eco-friendly
- With a built-in thermal break, this door is suitable for both cold and warm climates
- Multiple glazing window and insert options add value to any home
- Available in six designs: long and short raised panel, long and short carriage house, ribbed panel and flush versions

See Page 11 for Panel Choices and Window Designs

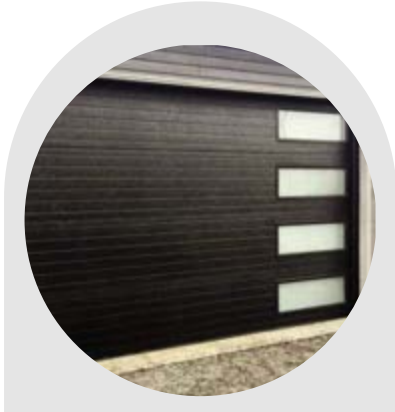

**Shown:**  
Design: Trafalgar Black



Shown:  
Design: Muskoka | White

## The Craft Series™

Represents the ultimate in style, durability and environmental friendliness. Our new three section taller panel design offers a truly distinct look while maintaining the quality and performance you would expect from a premium door, ideal for the homeowner who is looking for more than just curb appeal.



## Customize Your Look!

Choose your own custom colours to match your home!

## Colour Choices

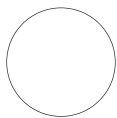

White



Sandtone

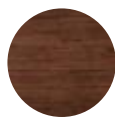

Walnut  
(28" only)



English  
Chestnut



Iron Ore

Actual door colour will vary from colour renditions

## Sizes

Available in two section heights



Shown:  
Design: Granville  
Walnut

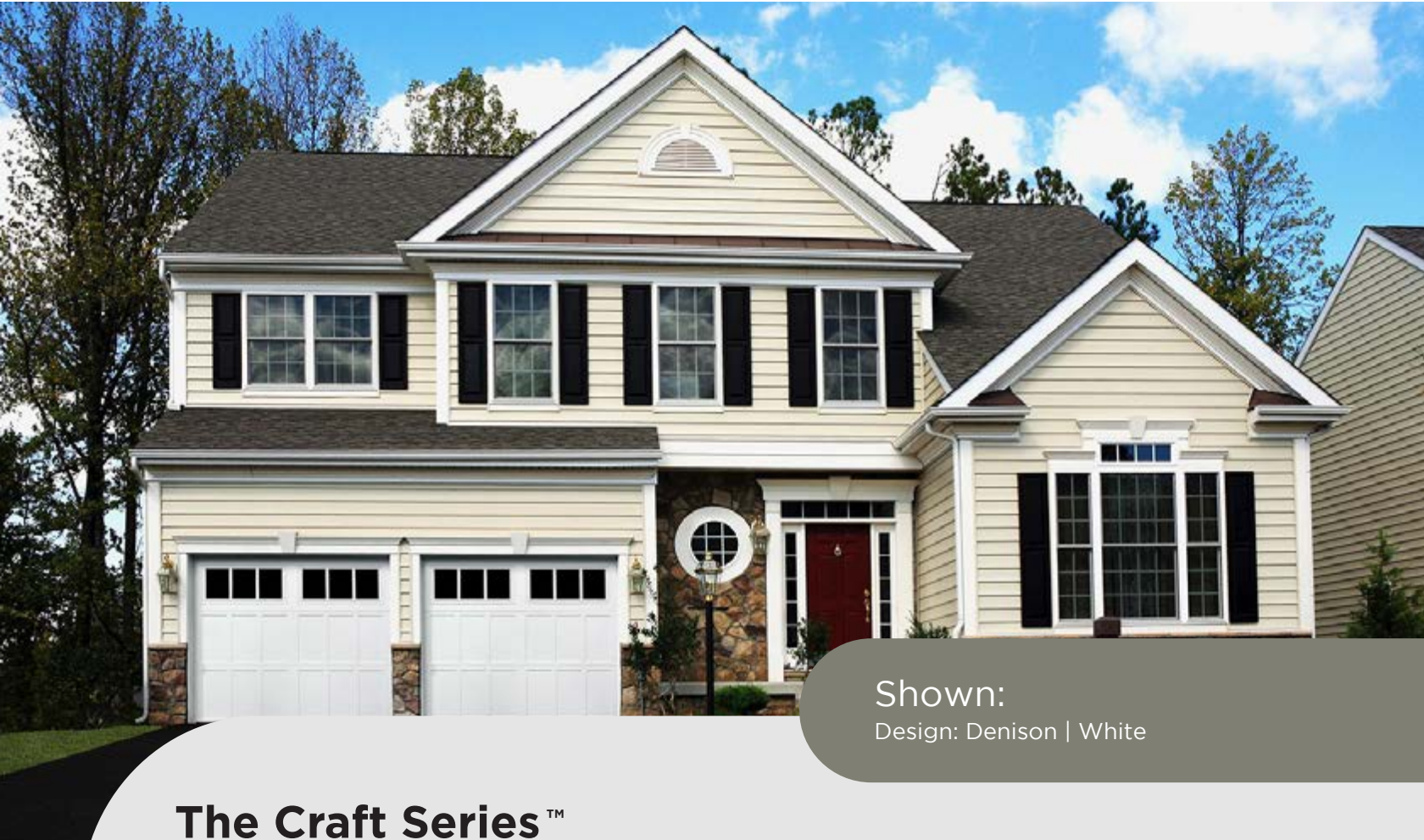

Shown:  
Design: Denison | White

## The Craft Series™

Our premium residential offering, representing the ultimate in style, durability and environmental friendliness. The three-section, 1<sup>3/4</sup>" (44.5mm) thick, taller panel design with an R-value of 16.3 appeals to the discerning homeowner who wants a distinct look without having to make compromises on the quality of their garage door.

## Features and Options

- 26-gauge, pebble embossed exterior and interior steel back sheet
- Environmentally-friendly polyurethane insulation, 100% CFC free
- Built-in thermal break prevents cold/heat transfer from the exterior to the interior of the door

See Page 12 for Panel Choices  
and Window Designs

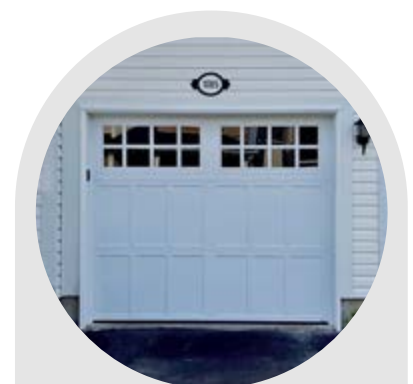

Shown:  
Design: Denison  
White



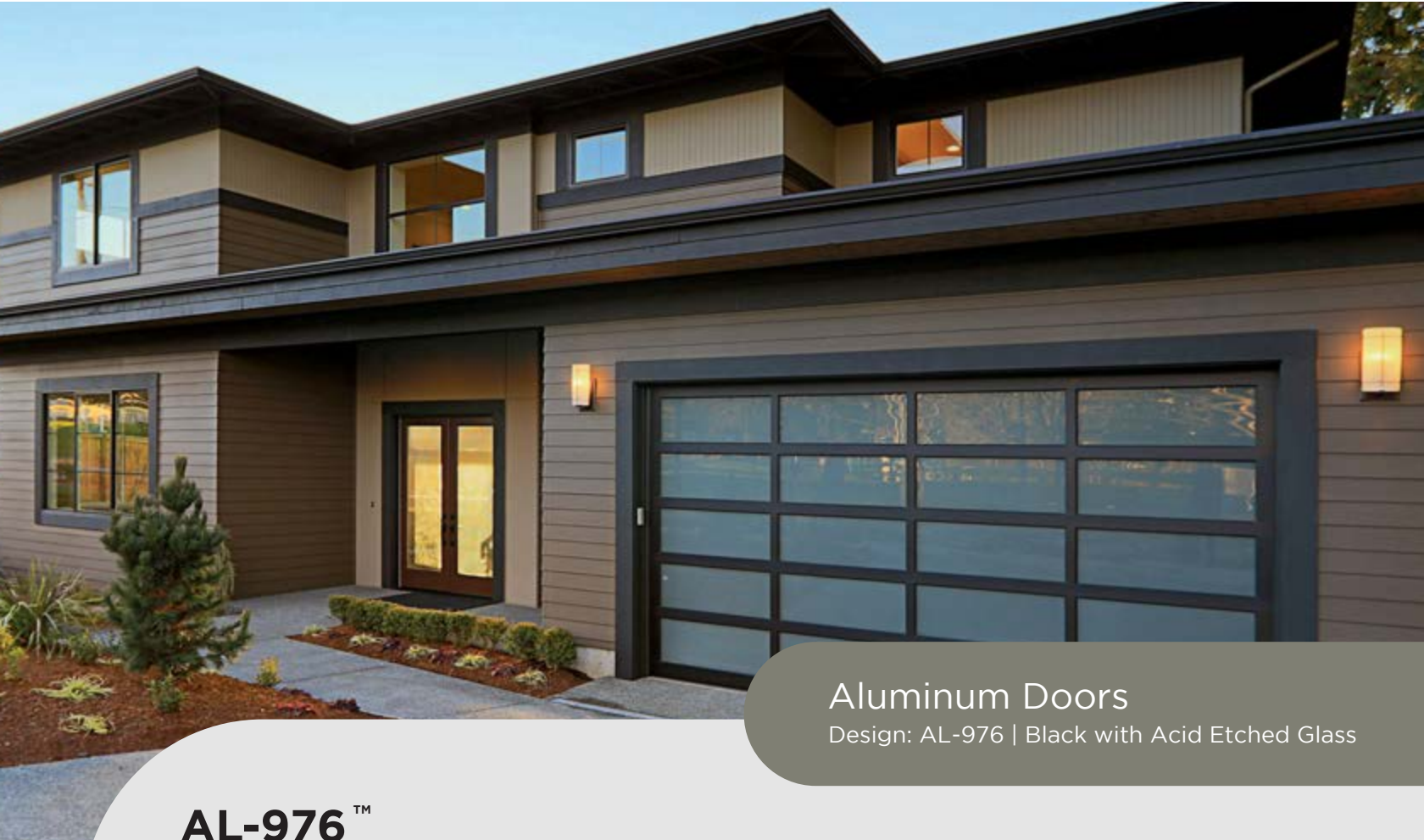

## Aluminum Doors

Design: AL-976 | Black with Acid Etched Glass

### AL-976™

Our most popular Aluminum Door, manufactured since 1976, offers a variety of options where superior strength, maximum visibility and exceptional light transmission are required. Its unique and durable design allows customized configurations for openings up to 24' (7.32m) wide. This modern look can add class to any home.

## Features and Options

- 1<sup>3</sup>/<sub>4</sub>" (44.5mm) thickness
- Clear anodized finish standard
- Tongue and groove section with weather seal inhibits air infiltration
- Available with various glazing options: single, insulated, tinted, tempered or specialty

See Page 13 for Panel Choices and Window Designs



## Customize Your Look!

Choose your own custom colours to match your home!

### 5 Year

Limited warranty on door finish

### 1 Year

Limited warranty workmanship and materials



## Wood Overlay Options

Design: F06 | Medium Oak

### Kanata Executive Line

Kanata Executive Line doors combine elegant design with high energy efficiency. Featuring a polyurethane-insulated base with a premium wood overlay, these doors offer superior strength, durability, and thermal protection (R-16.3+). With 44.5mm insulation, a tongue-and-groove design, and a thermal break. Ideal for energy-conscious homeowners wanting design flexibility.

### Key Benefits:

- New Wood Door in Multiple Grains
- High-quality, versatile and eco-friendly
- With a built-in thermal break, this door is suitable for both cold and warm climates
- Available in 24 unique wood panel designs, each offered in 5 rich wood color options



Overlay panel is 3" thick

### Colour Choices

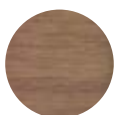

Medium Oak



Mahogany



Natural



Slate Dark Grey



Dark Walnut



### Customize Your Look!

Choose your own custom colours to match your home!

# LiftMaster

LiftMaster is the #1 brand of professionally-installed residential garage door systems and commercial door operators. From garages to gates, make your home's busiest entryways smarter, safer and more secure with LiftMaster's professionally installed home access solutions.

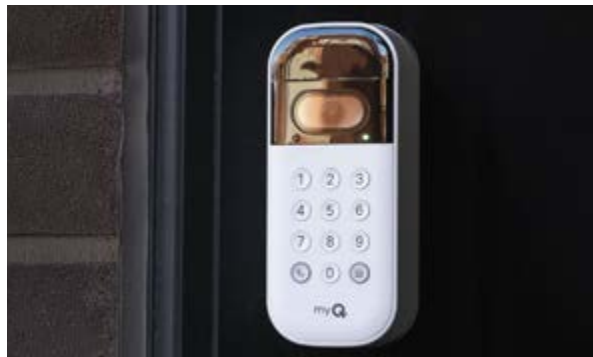

## Garage Organization

A variety of garage organization offers solutions all made from high-grade steel. Our back plates have been engineered to disperse the workload throughout the wall so you can hang whatever you want, wherever you want. Available in colors: Graphite, Dove Grey, Sandstone, White, Black, and Blue.

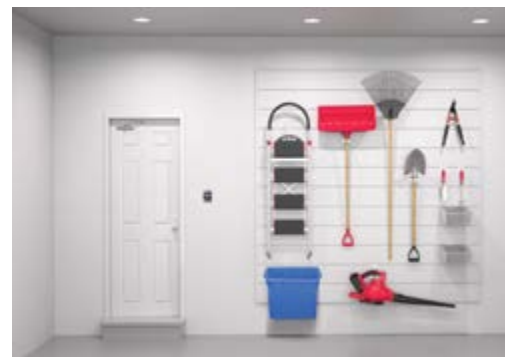
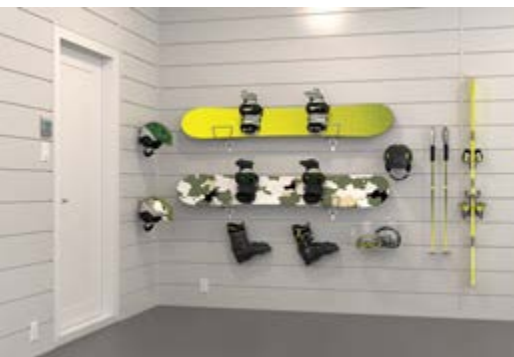



# Measurements & Specifications

## KANATA COLLECTION

### Stamp Designs



### Window Designs/Inserts

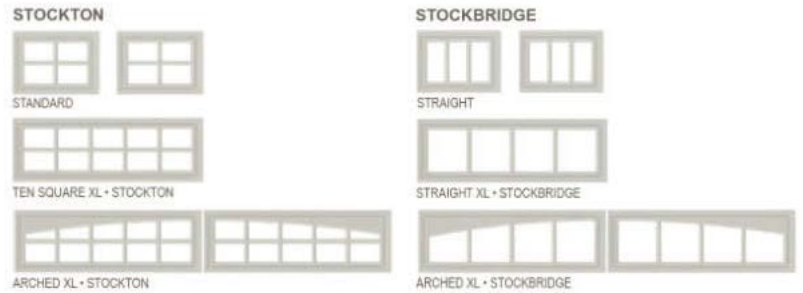

## KANATA COLLECTION

### Product Selection Guide & Specifications

EXTERIOR/INTERIOR STEEL BACKSHEET	26-GAUGE, PEBBLE EMBOSSED
HORIZONTAL REINFORCEMENT STRIP	25-GAUGE (2 PER PANEL)
END STILES - WHITE GALVANIZED	20-GAUGE
MAXIMUM STANDARD WIDTH	18'0" (5.49m)
MAXIMUM STANDARD HEIGHT	3" (76mm) INCREMENTS
SECTION HEIGHT	18", 21", & 24" (457, 533 & 610mm)
WARRANTY	LIMITED LIFETIME SEE WARRANTY SHEET
STANDARD RADIUS	15" (12" AVAILABLE UPON REQUEST)

### Side View Illustration

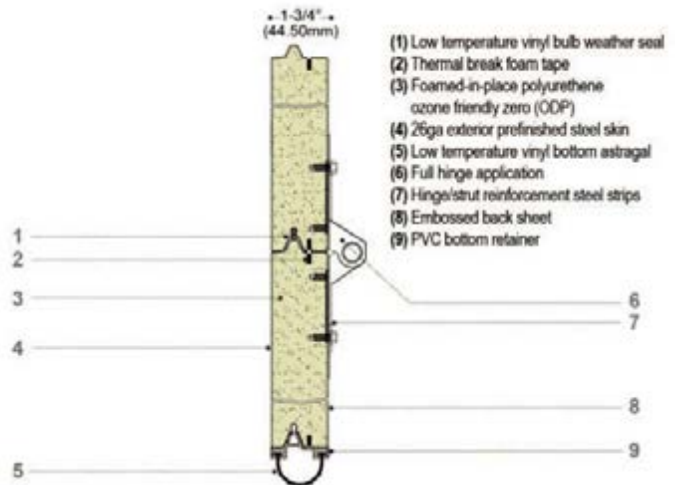



## CRAFT SERIES

### Panel Choices



Visit [upwardor.com](http://upwardor.com) to explore Panel choices and Window designs

### Window Inserts

#### STOCKTON



EIGHT SQUARE



ARCHED

#### STOCKBRIDGE

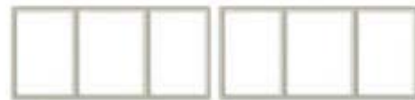

STRAIGHT



ARCHED

## CRAFT SERIES

### Product Selection Guide & Specifications

THICKNESS/PRODUCT TYPE	1-3/4" (44.50mm)
EXTERIOR/INTERIOR STEEL BACKSHEET	26-GAUGE, PEBBLE EMBOSSED
INSULATION TYPE/FOAM PROCESS	ZERO ODP POLYURETHANE/CONTINUOUS
R-VALUE/U-VALUE	16.3/0.06
SECTION JOINT	TONGUE & GROOVE
HORIZONTAL REINFORCEMENT STRIP	25-GAUGE (2 PER PANEL)
END STILES – WHITE GALVANIZED	20-GAUGE
AVAILABLE WIDTHS	8', 9', 12', & 16'
MAXIMUM HEIGHT	8' & 7'
SECTION HEIGHT	28" & 32" (711 & 813mm)
WARRANTY	LIMITED LIFETIME <small>SEE WARRANTY SHEET</small>
HARDWARE WARRANTY	1-YEAR
STANDARD RADIUS	20"
CLEARANCE AT HEADER	23" MIN

### Side View Illustration

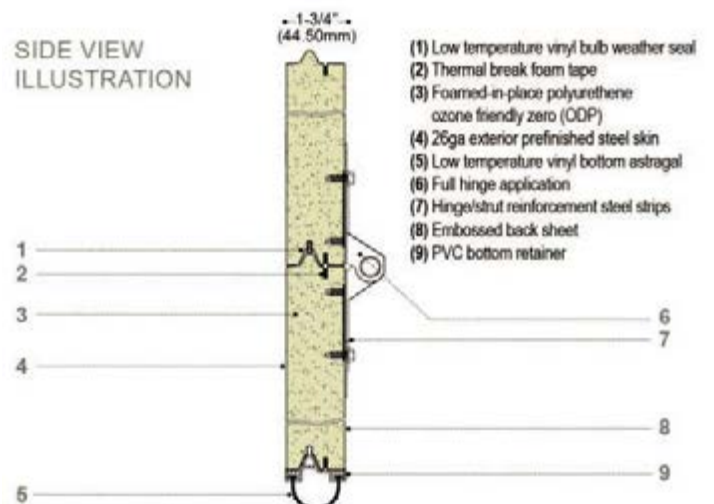

# ALUMINUM DOORS

## Cross Section

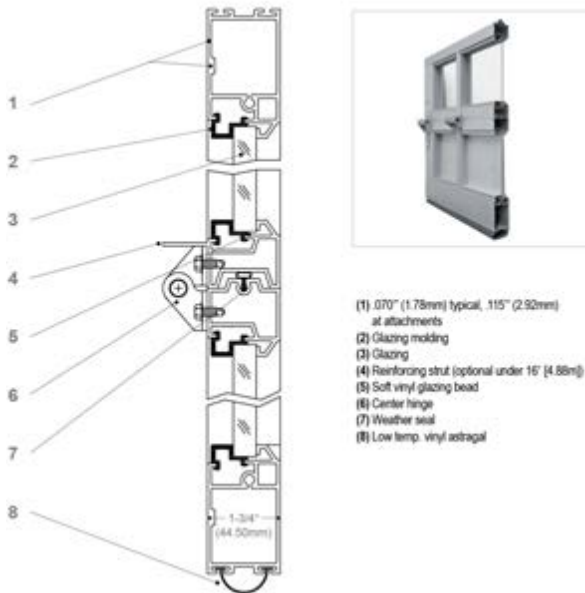

Visit [upwardor.com](http://upwardor.com) to explore Panel choices and Window designs

# KANATA EXECUTIVE LINE

## Product Selection Guide & Specifications

Thickness/Product Type	3" (76.2mm)
Exterior/Interior Steel Backsheet	26-Gauge
Insulation Type/Foam Process	Zero ODP Polyurethane/Continuous
R-Value/U-Value	16.3/0.06 +
Section Joint	Tongue & Groove
Horizontal Reinforcement Strip	24-Gauge (2 Per Panel)
End Stiles - White Galvanized	20-Gauge
Maximum Standard Width	18'0" (5.49m)
Section Height	18", 21", & 24", 28" & 32" (457, 533, 610, 711, 813 mm)
Warranty	Limited Lifetime SEE WARRANTY SHEET
Hardware Warranty	1-Year

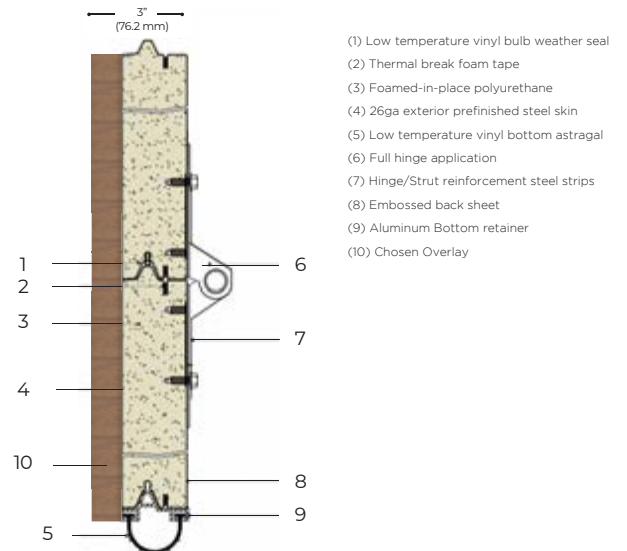

Overlay Wood Options: Clear Cedar, Red Grandis  
 Inlay Options: Flush Grooved  
 Top Section Options: Straight, Arched  
 Glass Options: Clear/Acid Etched, Clear/Super Grey, Clear/Clear

# KANATA EXECUTIVE LINE

## Window Inserts

STOCKTON

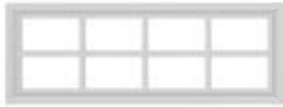

EIGHT SQUARE



ARCHED

STOCKBRIDGE



STRAIGHT



ARCHED

## Door Designs



F01

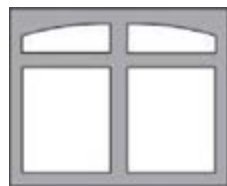

F01A

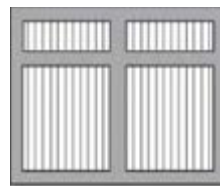

T01

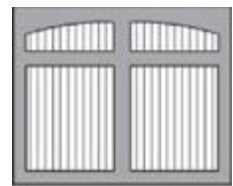

T01A

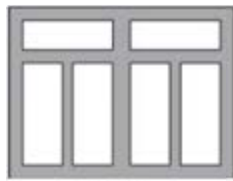

F02



F02A

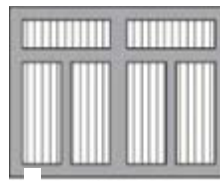

T02A

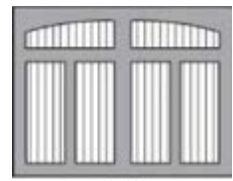

T02A

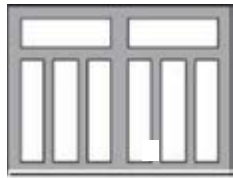

F03A

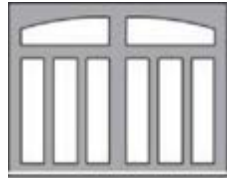

F03A

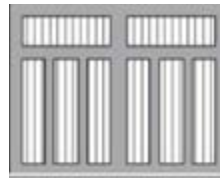

T03

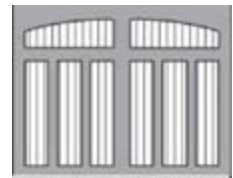

T03A

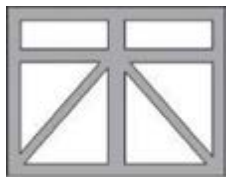

F04

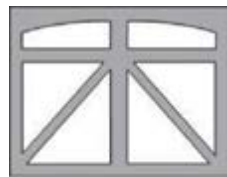

F04A

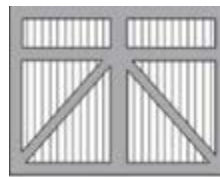

T04



T04A

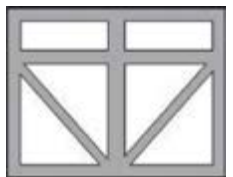

F05

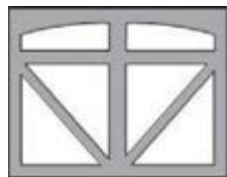

F05A

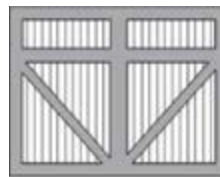

T05



T05A

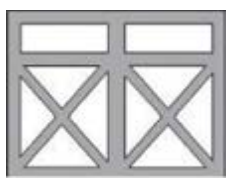

F06

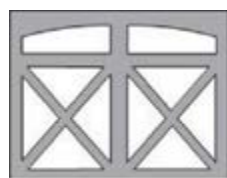

F06A

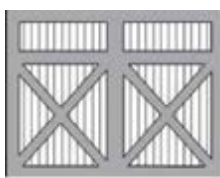

T06

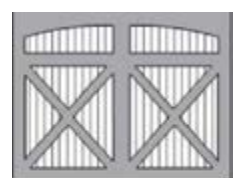

T06A

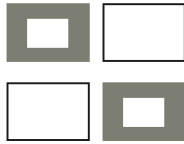

# upwardor

---

Garage Doors Designed for Life

1-800-667-3367

T: 905-876-3667

F: 905-876-3533

[sales@upwardor.com](mailto:sales@upwardor.com)

