

# upwardor

---

Garage Doors Designed for Life

RESIDENTIAL COLLECTION

# Trust Upwardor Quality Craftsmanship

---



For over **45** years, thousands of homeowners every year choose Upwardor. We are a leader in manufacturing quality doors that last! Our Dealers are selectively chosen because of their attention to detail and customer service.

Call **1-800-667-3367** to find out more  
or visit **[upwardor.com](http://upwardor.com)**

**Telephone 905-876-3667**

**Fax: 905-876-3533**

**Email: [sales@upwardor.com](mailto:sales@upwardor.com)**



# Quality Crafted, Uniquely Styled.

Since 1974

Shown:  
A1976 Black with  
Acid etched glass

RESIDENTIAL LINE



upwardor





Shown:  
Sheridan XL White

## The Kanata Collection™

Combines style, durability and environmental friendliness. Polyurethane insulation is foamed in place, which ensures a consistent density and significant panel strength. With a 1-3/4" (44.50mm) thickness, R-value of 16.3, enhanced tongue and groove joint and a true thermal break, the Kanata Collection™ is an excellent choice for those who are looking for a high-quality, energy efficient residential garage door.



## Customize Your Look!

Choose your own custom colours  
to match your home!

## Colour Choices



Shown:  
Flush Black





## The Kanata Collection™

**Upwardor®** offers several design and decorative insert options, adding a custom touch to your garage door. Window inserts are interchangeable, providing a classic or decorative look to complement and add value to your home. Frames and inserts are carefully colour-matched and are UV protected.

## Features and Options

- High-quality, versatile and eco-friendly
- With a built-in thermal break, this door is suitable for both cold and warm climates
- Multiple glazing window and insert options add value to any home
- Available in six designs: long and short raised panel, long and short carriage house, ribbed panel and flush versions

**Shown:  
Trafalgar Black**



Visit [upwardor.com](https://upwardor.com) to explore  
Panel choices and Window designs





## Craft Series

Shown:  
Muskoka White

## The Craft Series™

Our premium residential offering, represents the ultimate in style, durability and environmental friendliness. The three-section, 1-3/4 thick, taller panel design with an R-value of 16.3 appeals to the discerning homeowner who wants a distinct look without having to make compromises on the quality of their garage door

## Features and Options

- 26-gauge, pebble embossed exterior and interior steel back sheet
- Environmentally friendly polyurethane insulation, 100% CFC free
- Built in thermal break prevents cold/heat transfer from the exterior to the interior of the door

Shown:  
Denison White



Visit [upwardor.com](https://upwardor.com) to explore  
Panel choices and Window designs



Shown:  
Denison White

## The Craft Series™

Represents the ultimate in style, durability and environmental friendliness. Our new three section taller panel design offers a truly distinct look while maintaining the quality and performance you would expect from a premium door, ideal for the homeowner who is looking for more than just curb appeal.



## Customize Your Look!

Choose your own custom colours  
to match your home!

## Colour Choices



WHITE



SANDTONE



WALNUT  
(28" ONLY)

Actual door colour will vary from colour renditions.

Shown:  
Granville Walnut







## Aluminum Doors

Shown:  
A1976 Black with Acid etched glass

### AL-976™

Is our Most Popular Aluminum Door, Manufactured since 1976, offers a variety of options where superior strength, maximum visibility and exceptional light transmission are required. Its unique and durable design allows customized configurations for openings up to 24' (7.32m) wide. This modern look can add class to any home

## Features and Options

- 1-3/4" (44.50mm) thickness
- Clear anodized finish standard
- Tongue and groove section with weather seal inhibits air infiltration.
- Available with various glazing options: single, insulated, tinted, tempered or specialty

Visit [upwardor.com](https://upwardor.com) to explore Panel choices and Window designs

## Customize Your Look!



**Choose your own custom colours to match your home!**

### 5 Year

Limited warranty on door finish

### 1 Year

Limited warranty workmanship and materials





## Modern Design

Shown:  
Solalite in black with Opal Glazing

### Solalite™

Ultra modern design, The Solalite™ door is an exceptional example of innovation and engineering. This door is impact, corrosion and moisture-resistant. The Solalite's sleek and contemporary appearance blends with current architectural trends. A door sure to stand out on your block!

## Features and Options

- Manufactured from 2" thick (50.8mm) corrosion-resistant aluminum extrusions.
- Standard clear anodized finish.
- Polycarbonate, translucent glazing is lightweight, virtually unbreakable and energy efficient.
- Continuous hinge design inhibits water build-up between sections and prevents air infiltration, which maximizes thermal resistance.

## Customize Your Look!



Choose your own custom colors to match your home!

Visit [upwardor.com](https://upwardor.com) to explore Panel choices and Window designs.



New to the Kanata™ Collection

## Thermalex 450-20S

Shown:  
Black

### Smooth Residential Door

Polyurethane insulation is foamed in place, which ensures a consistent density and significant panel strength. With a 44.5 mm (1-3/4") thickness, R-value of 16.3. Completely Smooth 20 ga face and our new tongue and groove design with a true thermal break.

### Key Benefits:

- High-quality, versatile and eco-friendly
- With a built-in thermal break, this door is suitable for both cold and warm climates
- Multiple glazing window and insert options add value to any home.
- Available in Smooth Flush

### Colour Choices



Black



White



### Customize Your Look!

Choose your own custom colours to match your home!







New to the Kanata™ Collection

**Thermalex 500-20S**

Shown:  
Black

## Smooth Residential Door

Polyurethane insulation is foamed in place, which ensures a consistent density and significant panel strength. With a 50.8 mm (2") thickness, R-value of 18.4. Completely Smooth 20 ga face and our new tongue and groove design with a true thermal break.

## Key Benefits:

- High-quality, versatile and eco-friendly
- With a built-in thermal break, this door is suitable for both cold and warm climates
- Multiple glazing window and insert options add value to any home.
- Available in Smooth Flush

## Colour Choices



Black



White



## Customize Your Look!

Choose your own custom colours to match your home!

# Measurements & Specifications

## KANATA COLLECTION

### Product Selection Guide & Specifications

EXTERIOR/INTERIOR STEEL BACKSHEET	26-GAUGE, PEBBLE EMBOSSED
HORIZONTAL REINFORCEMENT STRIP	25-GAUGE (2 PER PANEL)
END STILES – WHITE GALVANIZED	20-GAUGE
MAXIMUM STANDARD WIDTH	18'0" (5.49m)
MAXIMUM STANDARD HEIGHT	3" (76mm) INCREMENTS
SECTION HEIGHT	18", 21", & 24" (457, 533 & 610mm)
WARRANTY	LIMITED LIFETIME SEE WARRANTY SHEET
STANDARD RADIUS	15" (1" AVAILABLE UPON REQUEST)

### Side view illustration

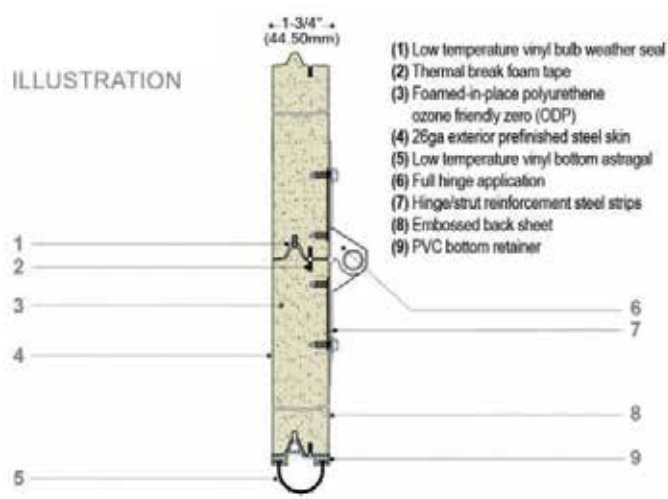

## KANATA COLLECTION

### Stamp Designs

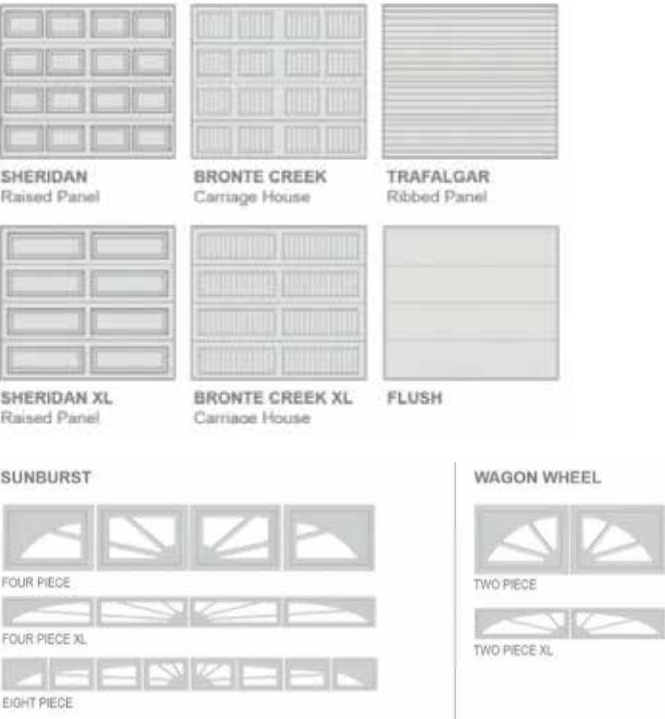

### WindowDesigns/ Inserts

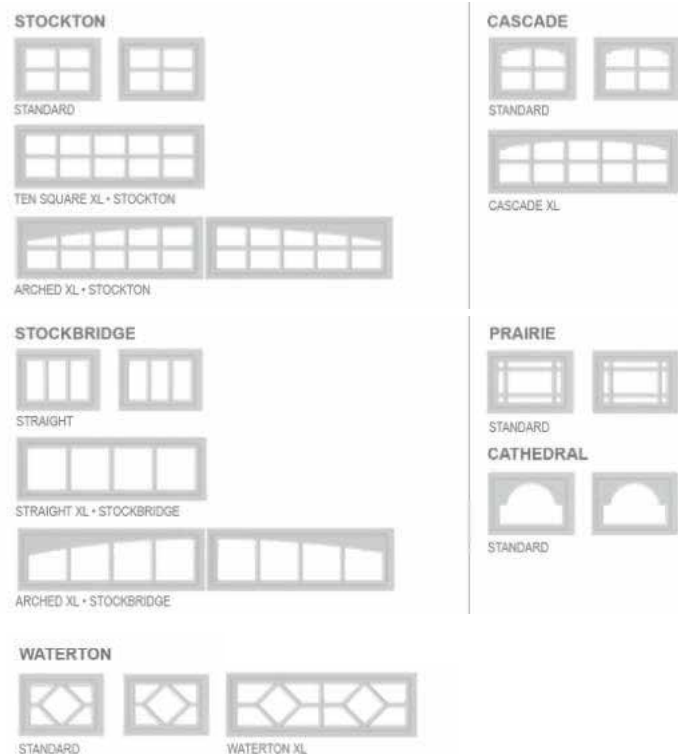



## CRAFT SERIES

### Product Selection Guide & Specifications

THICKNESS/PRODUCT TYPE	1-3/4" (44.50mm)
EXTERIOR/INTERIOR STEEL BACKSHEET	26-GAUGE, PEBBLE EMBOSSED
INSULATION TYPE/FOAM PROCESS	ZERO ODP POLYURETHANE/CONTINUOUS
R-VALUE/U-VALUE	16.3/0.06
SECTION JOINT	TONGUE & GROOVE
HORIZONTAL REINFORCEMENT STRIP	25-GAUGE (2 PER PANEL)
END STILES – WHITE GALVANIZED	20-GAUGE
AVAILABLE WIDTHS	8', 9', 12', & 16'
MAXIMUM HEIGHT	8' & 7'
SECTION HEIGHT	28" & 32" (711 & 813mm)
WARRANTY	LIMITED LIFETIME SEE WARRANTY SHEET
HARDWARE WARRANTY	1-YEAR
STANDARD RADIUS	20"
CLEARANCE AT HEADER	23" MIN

### Side view illustration

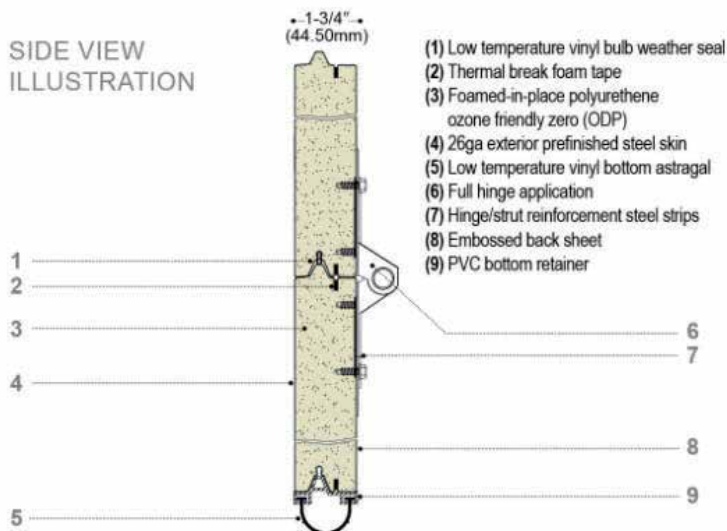

## CRAFT SERIES

### Panel Choices



Visit **upwardor.com**  
to explore Panel choices  
and Window designs

### Window Inserts

#### STOCKTON



EIGHT SQUARE



ARCHED

#### STOCKBRIDGE



STRAIGHT



ARCHED

# Measurements & Specifications

## ALUMINUM DOORS

### Cross Section

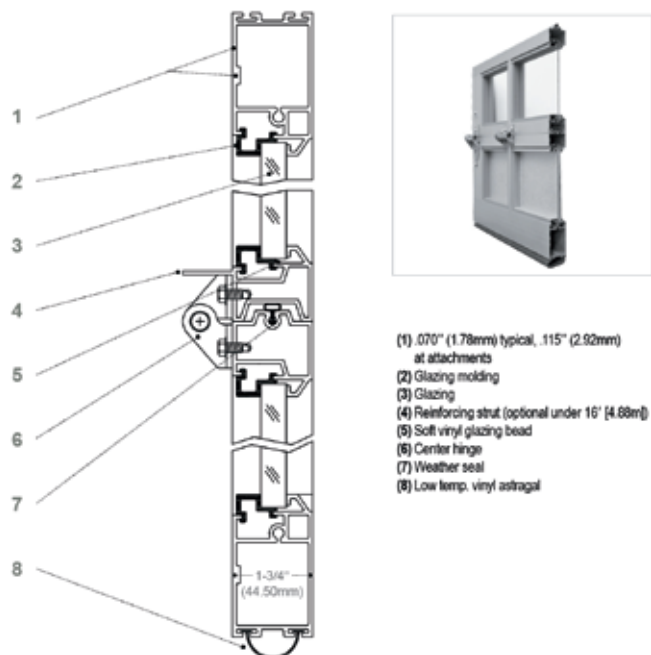

Visit [upwardor.com](http://upwardor.com) to explore Panel choices and Window designs

## SOLALITE

### Cross Section

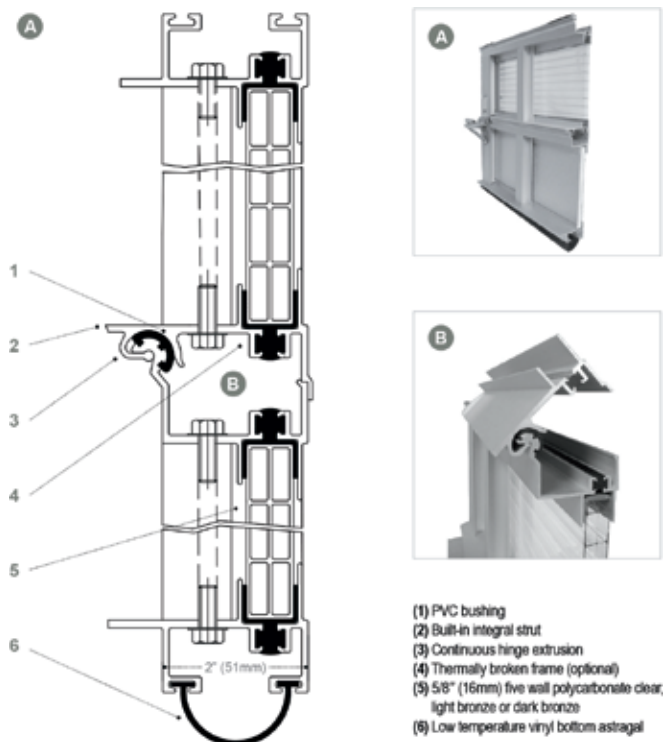

Visit [upwardor.com](http://upwardor.com) to explore Panel choices and Window designs





For more product information visit:

**upwardor.com**

---



# upwardor

---

Garage Doors Designed for Life

1-800-667-3367

Telephone 905-876-3667

Fax: 905-876-3533

Email: [sales@upwardor.com](mailto:sales@upwardor.com)